

FB15 range steady beacons

Ex d, weatherproof



Overview

These certified steady beacons have been designed for use in potentially explosive atmospheres and harsh environmental conditions.

The enclosures are suitable for use offshore or onshore, where lightweight combined with corrosion resistance is required.

The housings are manufactured completely from a UV stable, glass reinforced polyester.* Stainless steel screws and mounting bracket are incorporated ensuring a totally corrosion-free product.

Units can be painted to customer specification and supplied with identification labels.

*UL pipe mount variants use an alloy lens cover, painted black where applicable.

Features

- Zones 1, 2, 21 & 22
- Exd IIC T3/T4
- ATEX certified, Ex II 2GD
- UL certified for USA and Canada:
 - Hazardous locations:
 - Class I, Div. 2, Groups A, B, C & D
 - Class I, Zone 1, AExd IIC T3/T4
 - Ordinary locations: visual-signal device
- TR CU certified
- INMETRO certified
- CQST certified
- IECEx Gb, Db
- Certified temperature from -55°C to $+70^{\circ}\text{C}$
- Pipe mount or direct mount enclosure
- Corrosion-free GRP
- 60W filament bulb
- Optional stainless steel backstrap
- Various lens colours
- Optional cast or wire lens guard
- Up to 3 x M20 or 3 x M25 entries



Certifications

ATEX Ex d	Cert. no. Baseefa 04ATEX0009X Certified to: EN60079-0, EN60079-1, EN60079-31 Ex II 2GD Ex db IIC T3/T4 Gb, Ex tb IIIC T135°C/T200°C Db
IECEX Ex d	Cert. no. IECEx BAS 05.0048X Certified to: IEC60079-0, IEC60079-1, IEC60079-31 Ex db IIC T3/T4 Gb, Ex tb IIIC T135°C/T200°C Db
UL Haz Locs	Cert. no. E187894 Class I, Div 2 Groups A,B,C & D Class I, Zone 1 AEx d IIC
UL Ord Locs	Cert. no. E187894. Visual signal device
TR CU Ex d	1Ex db IIC T3/T4 Gb X, Ex tb IIIC T135°C/T200°C Db X
INMETRO Ex d	Ex d IIC T3/T4 Gb, Ex tb IIIC T135°C/T200°C Db
CQST Ex d	Ex db IIC T3/T4 Gb, Ex tb IIIC T135°C/T200°C Db

Specifications

Material	Body: glass reinforced polyester. (UL pipe mount - alloy lens cover) Lens: glass Backstrap: stainless steel 316 Wire guard (optional): stainless steel wire Cast guard (optional): aluminium LM25M
Finish	Natural black or painted to customer specification
Models	FB15 ATEX – available in direct mount version only FB15 UL – available in pipe and direct mount versions
Voltage	24, 48V d.c. - 110, 120, 230, 240V a.c.
Lamp type	60W GLS filament
Lamp holder	E27 as standard
Certified temp	60W : from -55°C to +55°C (T4) from -55°C to +70°C (T3)
Weight	Pipe mount: 2.6kg; direct mount: 3.0kg
Ingress protection	IP66 & IP67
Entries	ATEX version: Standard: 2 x M20 Optional: 1 x M20/M25, 3 x M20/M25 entries UL version: Standard pipe: ¾" NPT Standard direct: 2 x ¾" NPT Optional direct: 1 x ½"/¾" NPT or 3 x ½"/¾" NPT Dual UL/ATEX, UL/IECEX: Standard direct: 2 x ¾" NPT
Terminals	Direct mount: 12 x 2.5mm ² Pipe mount: 8 x 2.5mm ²
Label	Tag/duty label option

Electrical ratings:

Nominal voltage	d.c.		a.c.			
	24	48	110	120	230	240
Current (A) - 60W lamp	2.5	1.25	0.55	0.50	0.26	0.25

General arrangement drawing (all dimensions in mm)

Direct mount version

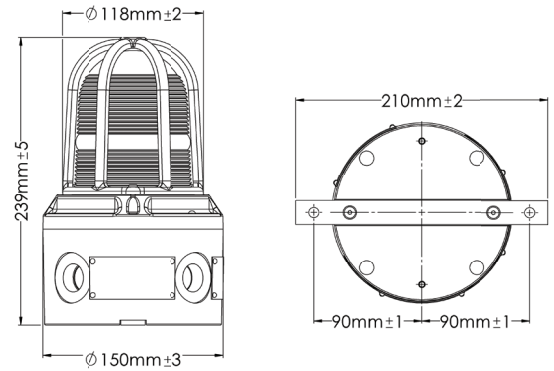

Pole mount version

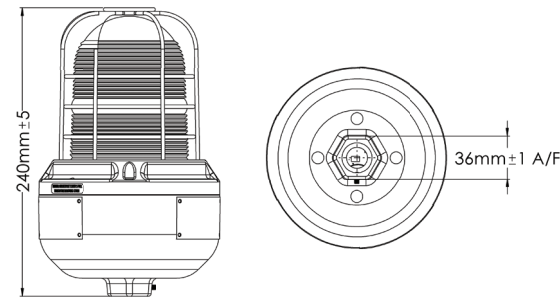

Ordering requirements

The following code is designed to help in selection of the correct unit. Build up the reference number by inserting the code for each component into the appropriate box

Model	Certification	Voltage	Lamp	Lens colour	Lens guard	Fixings	Options	Finish																																																			
FB15																																																											
	<table border="1"> <thead> <tr> <th>Certification</th> <th>Code</th> </tr> </thead> <tbody> <tr><td>ATEX</td><td>B</td></tr> <tr><td>IECEX</td><td>J</td></tr> <tr><td>Dual ATEX/UL</td><td>AU</td></tr> <tr><td>Dual IECEX/UL</td><td>JU</td></tr> <tr><td>UL</td><td>UL</td></tr> <tr><td>UL (ordinary location)</td><td>UW</td></tr> <tr><td>TR CU</td><td>G</td></tr> <tr><td>INMETRO</td><td>DM</td></tr> <tr><td>CQST</td><td>Q</td></tr> </tbody> </table>	Certification	Code	ATEX	B	IECEX	J	Dual ATEX/UL	AU	Dual IECEX/UL	JU	UL	UL	UL (ordinary location)	UW	TR CU	G	INMETRO	DM	CQST	Q		<table border="1"> <thead> <tr> <th>Wattage</th> <th>Code</th> </tr> </thead> <tbody> <tr><td>60</td><td>60</td></tr> </tbody> </table>	Wattage	Code	60	60		<table border="1"> <thead> <tr> <th>Guard</th> <th>Code</th> </tr> </thead> <tbody> <tr><td>None</td><td>N</td></tr> <tr><td>Cast</td><td>C</td></tr> <tr><td>Wire</td><td>W</td></tr> </tbody> </table>	Guard	Code	None	N	Cast	C	Wire	W		<table border="1"> <thead> <tr> <th>Option</th> <th>Code</th> </tr> </thead> <tbody> <tr><td>None</td><td>N</td></tr> <tr><td>Tag label</td><td>T*</td></tr> <tr><td>Duty label</td><td>D*</td></tr> <tr><td>Blanking plug</td><td>P</td></tr> </tbody> </table> <p>*Please specify. For UL/AU/JU, one label only</p>	Option	Code	None	N	Tag label	T*	Duty label	D*	Blanking plug	P										
Certification	Code																																																										
ATEX	B																																																										
IECEX	J																																																										
Dual ATEX/UL	AU																																																										
Dual IECEX/UL	JU																																																										
UL	UL																																																										
UL (ordinary location)	UW																																																										
TR CU	G																																																										
INMETRO	DM																																																										
CQST	Q																																																										
Wattage	Code																																																										
60	60																																																										
Guard	Code																																																										
None	N																																																										
Cast	C																																																										
Wire	W																																																										
Option	Code																																																										
None	N																																																										
Tag label	T*																																																										
Duty label	D*																																																										
Blanking plug	P																																																										
		<table border="1"> <thead> <tr> <th>Voltage</th> <th>Code</th> </tr> </thead> <tbody> <tr><td>24V d.c.</td><td>024</td></tr> <tr><td>48V d.c.</td><td>048</td></tr> <tr><td>110V a.c.</td><td>110</td></tr> <tr><td>120V a.c.</td><td>120</td></tr> <tr><td>230V a.c.</td><td>230</td></tr> <tr><td>240V a.c.</td><td>240</td></tr> </tbody> </table>	Voltage	Code	24V d.c.	024	48V d.c.	048	110V a.c.	110	120V a.c.	120	230V a.c.	230	240V a.c.	240		<table border="1"> <thead> <tr> <th>Lens colour</th> <th>Code</th> </tr> </thead> <tbody> <tr><td>Red</td><td>R</td></tr> <tr><td>Blue</td><td>B</td></tr> <tr><td>Green</td><td>G</td></tr> <tr><td>Amber</td><td>A</td></tr> <tr><td>Yellow</td><td>Y</td></tr> <tr><td>Clear</td><td>C</td></tr> </tbody> </table>	Lens colour	Code	Red	R	Blue	B	Green	G	Amber	A	Yellow	Y	Clear	C		<table border="1"> <thead> <tr> <th>Fixings</th> <th>Code</th> </tr> </thead> <tbody> <tr><td>Pipe mount</td><td>P*</td></tr> <tr><td>Direct mount without backstrap</td><td>D†</td></tr> <tr><td>Direct mount with backstrap</td><td>B†</td></tr> </tbody> </table> <p>*Only available on UL listings †Contact MEDC if 1/2" NPT is required for UL version</p>	Fixings	Code	Pipe mount	P*	Direct mount without backstrap	D†	Direct mount with backstrap	B†	<table border="1"> <thead> <tr> <th>Finish</th> <th>Code</th> </tr> </thead> <tbody> <tr><td>Natural black</td><td>N†</td></tr> <tr><td>Red</td><td>R</td></tr> <tr><td>Blue</td><td>B</td></tr> <tr><td>Yellow</td><td>Y</td></tr> <tr><td>Green</td><td>G</td></tr> <tr><td>White</td><td>W</td></tr> <tr><td>Special</td><td>S*</td></tr> </tbody> </table> <p>*Please specify †For UL pipe mount this is painted black</p>	Finish	Code	Natural black	N†	Red	R	Blue	B	Yellow	Y	Green	G	White	W	Special	S*
Voltage	Code																																																										
24V d.c.	024																																																										
48V d.c.	048																																																										
110V a.c.	110																																																										
120V a.c.	120																																																										
230V a.c.	230																																																										
240V a.c.	240																																																										
Lens colour	Code																																																										
Red	R																																																										
Blue	B																																																										
Green	G																																																										
Amber	A																																																										
Yellow	Y																																																										
Clear	C																																																										
Fixings	Code																																																										
Pipe mount	P*																																																										
Direct mount without backstrap	D†																																																										
Direct mount with backstrap	B†																																																										
Finish	Code																																																										
Natural black	N†																																																										
Red	R																																																										
Blue	B																																																										
Yellow	Y																																																										
Green	G																																																										
White	W																																																										
Special	S*																																																										